

Fig.1

Ubicazione area di studio

Scala 1:10.000

COROGRAFIA

(rilievo topografico - scala 1:350)

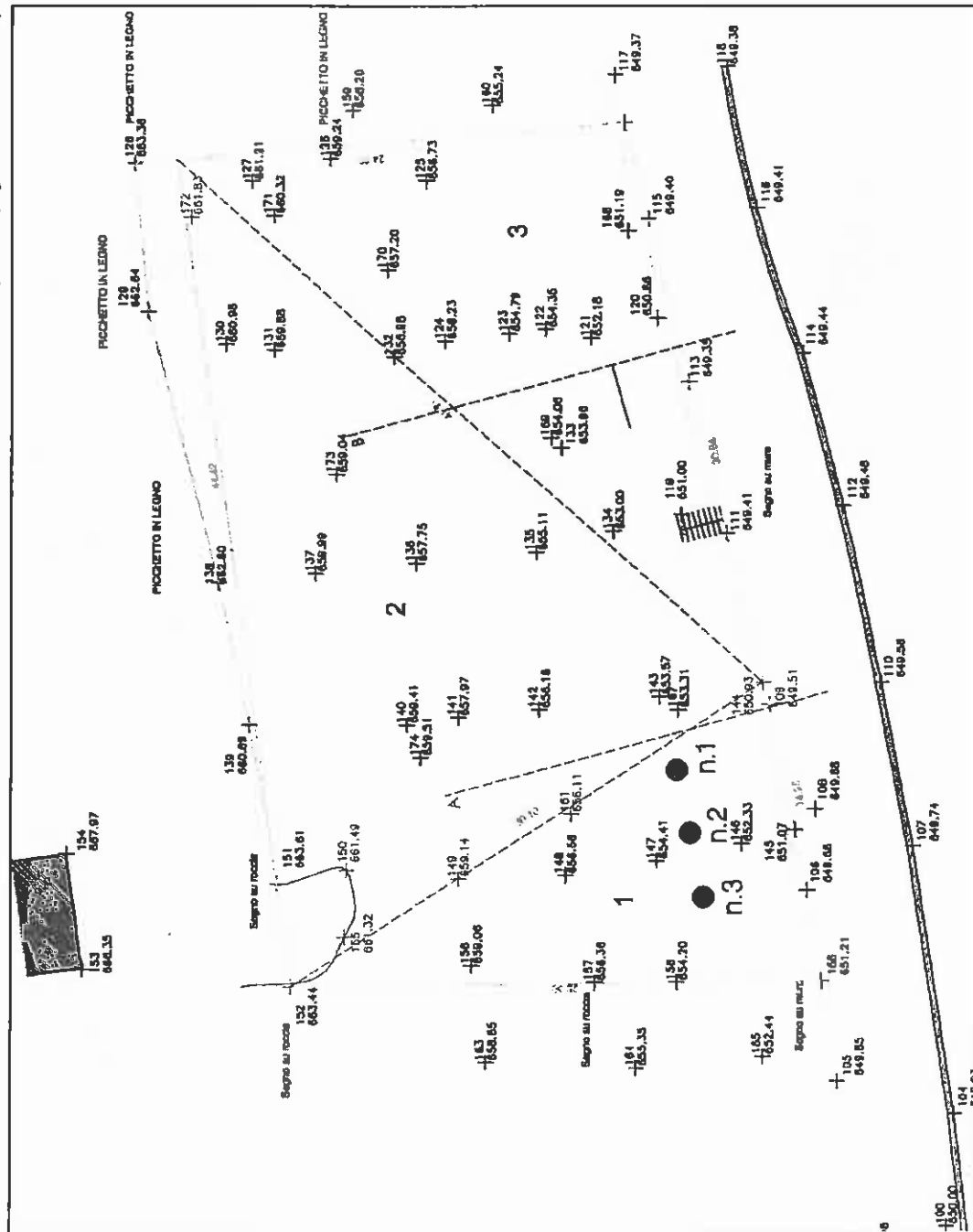
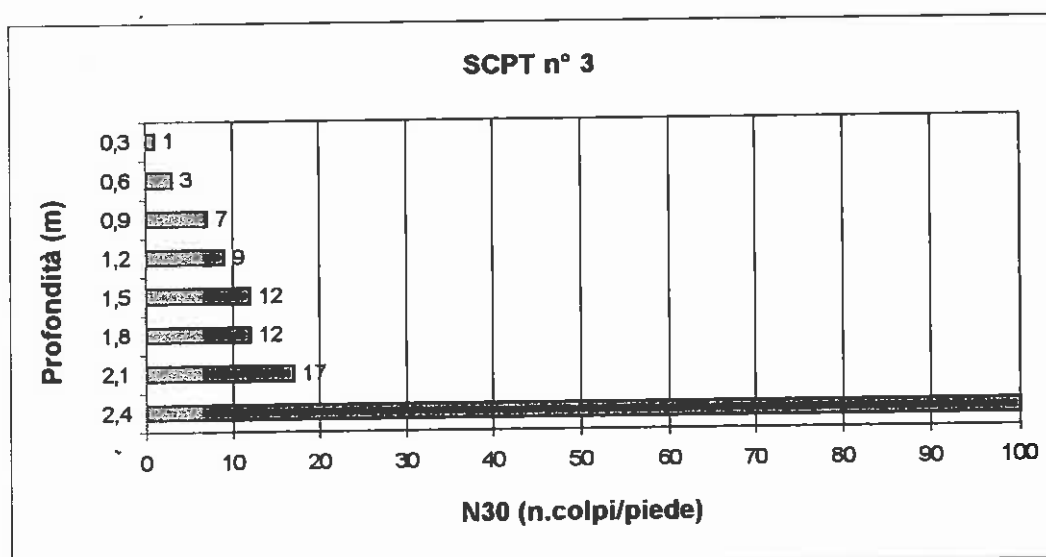
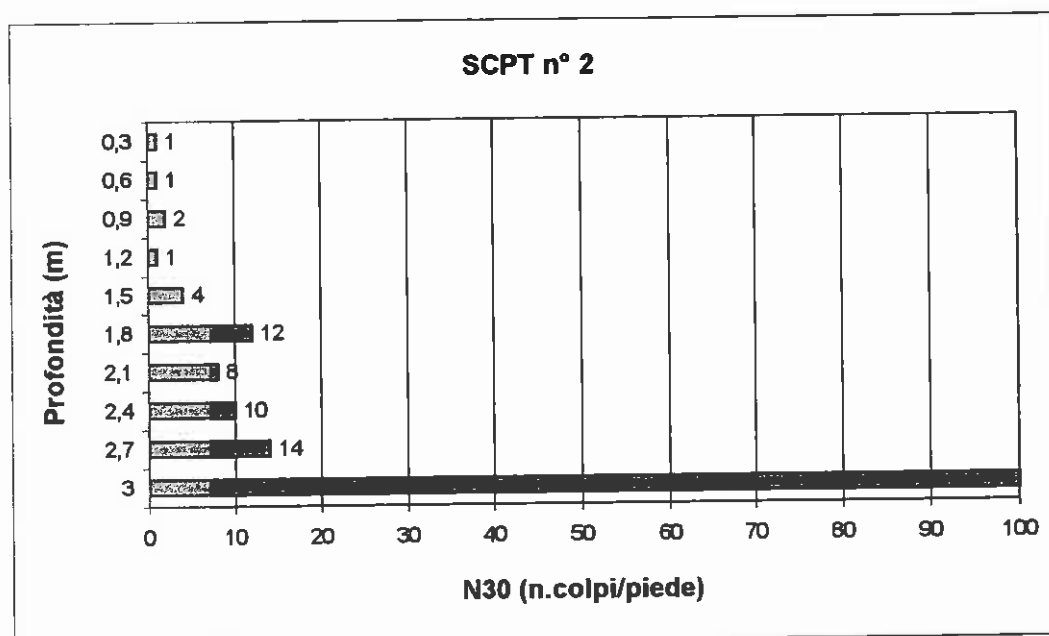
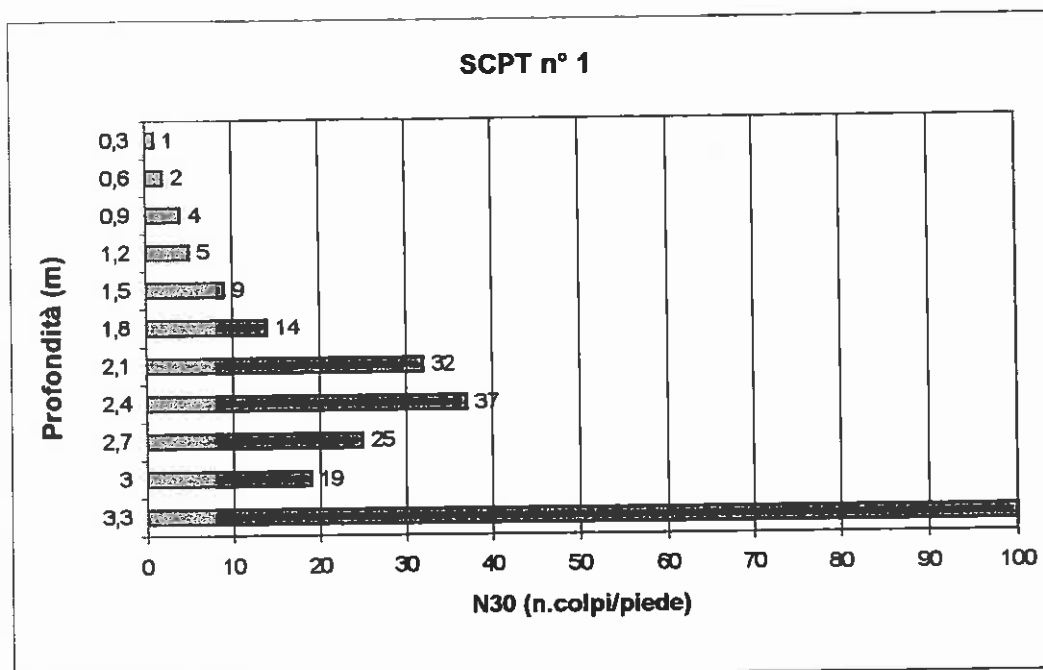

Fig.4: Ubicazione delle prove penetrometriche dinamiche (scpt) eseguite in sito



**Fig.5: risultati delle prove penetrometriche dinamiche effettuate**

*Allegato 3 - 01*